

Kit 1117

CHRYSLER 300M, 4-dr Sedan, 98-03

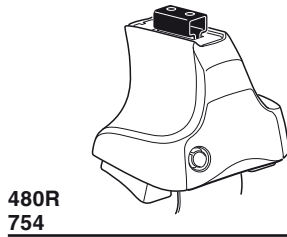

480R
754

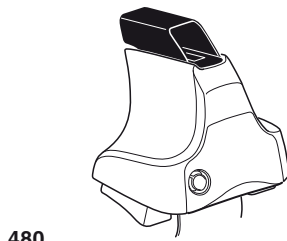
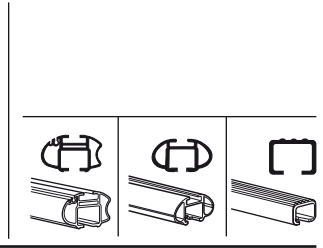

480

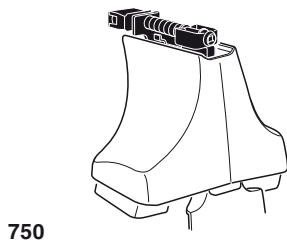
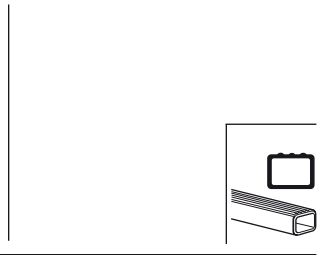

750

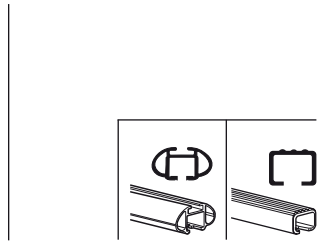

Max. 75kg
Max. 165 lbs

480R/754

480

750

x2 x2 x2 x4	x2	x2 x2 x4 x4	x2 x2	x2

401 x4

23 x1

24 x1

51 x2

34 mm
x2

41 mm
x2

x1

Kit

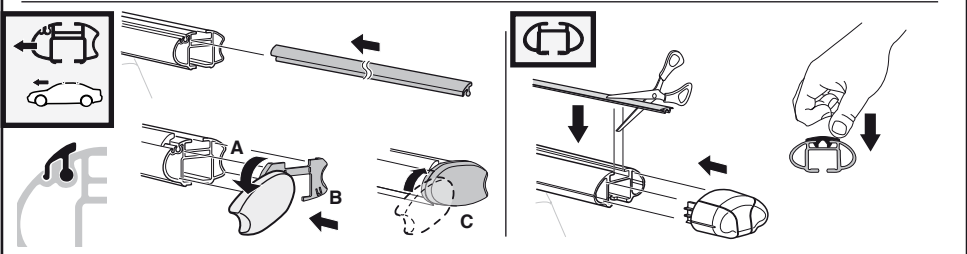
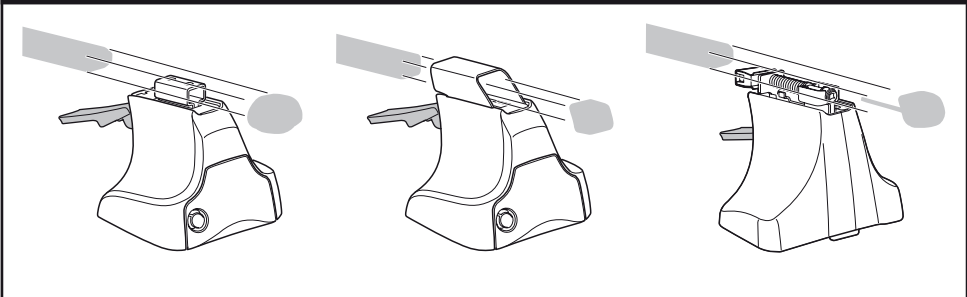

3

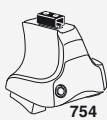

754

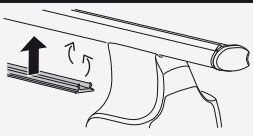
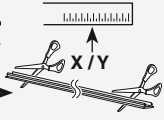

750

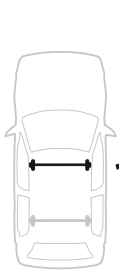

1

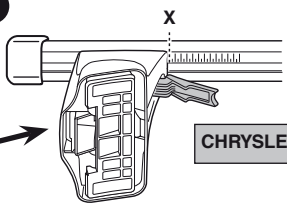

2



	X
CHRYSLER 300M, 4-dr Sedan, 98-03	34

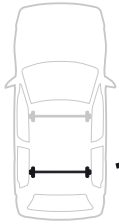

1

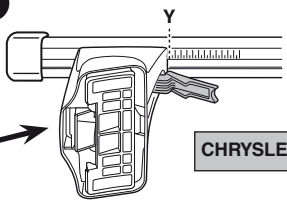

2

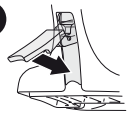

	Y
CHRYSLER 300M, 4-dr Sedan, 98-03	33



480R



480

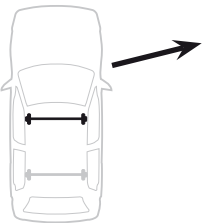

1

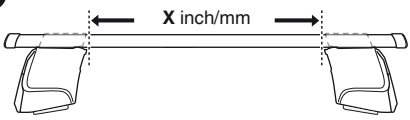

2



	X inch	X mm
CHRYSLER 300M, 4-dr Sedan, 98-03	39"	991 mm

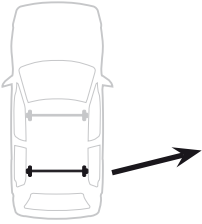

1

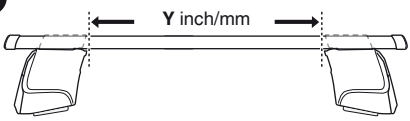

2



	Y inch	Y mm
CHRYSLER 300M, 4-dr Sedan, 98-03	38 5/8"	981 mm

4

CHRYSLER 300M, 4-dr Sedan, 98-03

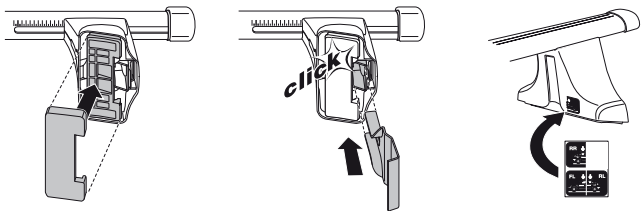
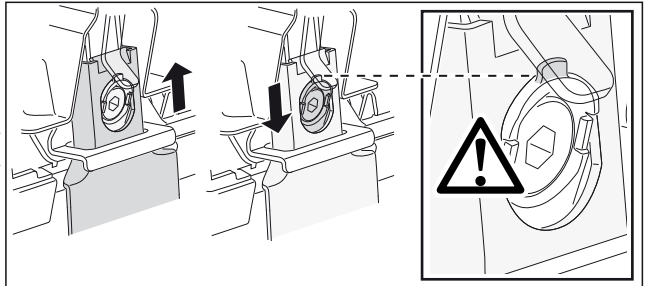
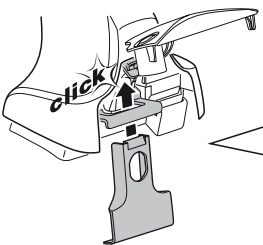
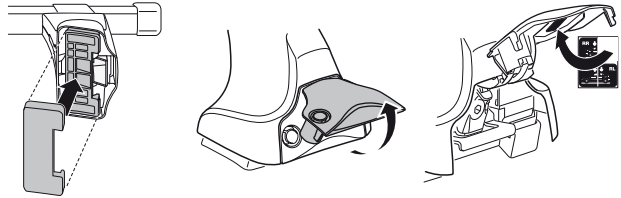
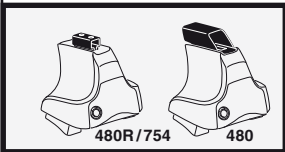
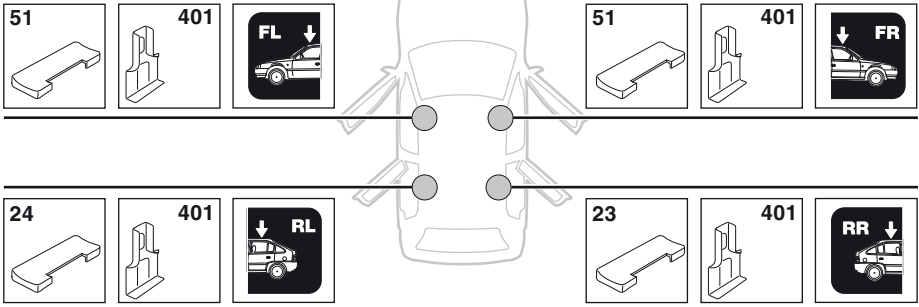

5

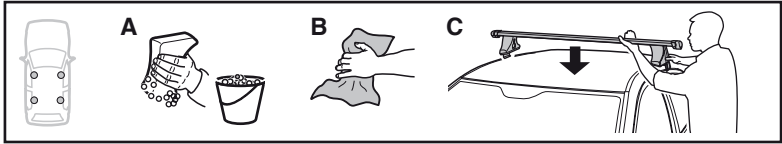

	X mm	Y mm	X inch	Y inch
CHRYSLER 300M, 4-dr Sedan, 98-03	300 mm	650 mm	11 3/4"	25 5/8"

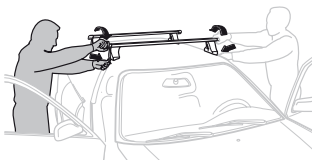
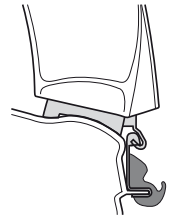
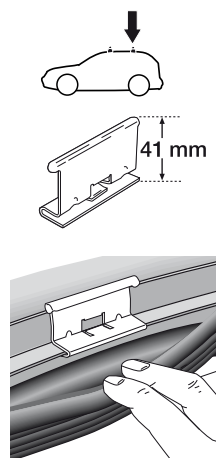
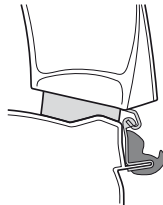
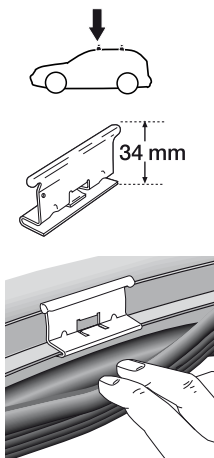
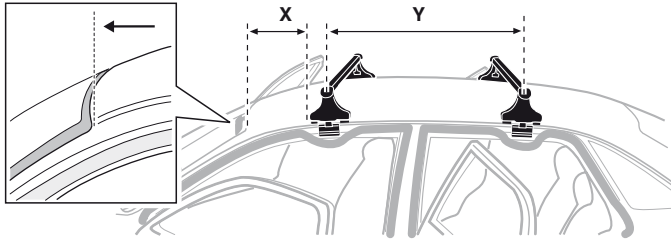

- GB/US** Tighten alternately
D Die Schrauben abwechselnd anziehen
F Serrer alternativement chaque côté
NL Afwisselend aan de linker- en de rechterkant aandraaien
I Alternare il serraggio delle viti
E Apretar alternativamente
PT Aperte alternadamente
S Dra åt växelvis
FIN Kierrä vuorotellen
EST Pinguldage vaheldumisi
LAT Pievelciēt pamīšus
LIT Užsukinkite pakaitomis
PL Śruby dokręcaj naprzemiennie
RU Затягивайте попеременно

- CZ** Pokręťta багаžníka dokręcaj dokręcaj naprzemiennie.
SK Dofahujtie striedavo
SLO Privijajte izmenično.
HR Naizmjernoćno zategnite
HU Egyarástól függetlenül szorítandó
GR Σφιγγετε εναλλάξ
TR Dönüştürülüşü için
中文 交替拧紧
한국어 번갈아가며 조이십시오.
日本語 交互に締め付けてください。
ไทย ชั้้นในแบบสลับ

6



480R/754



480

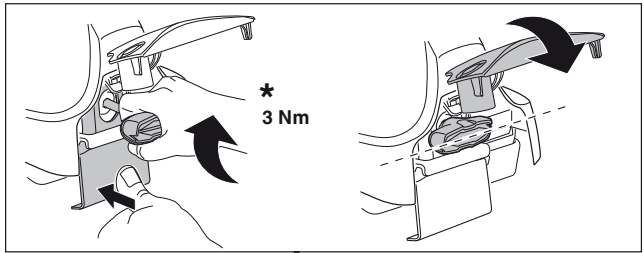
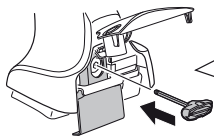

*
3 Nm

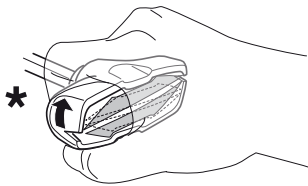

*

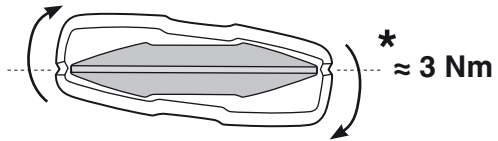

*
≈ 3 Nm

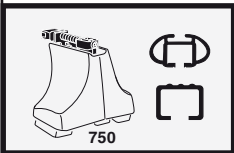
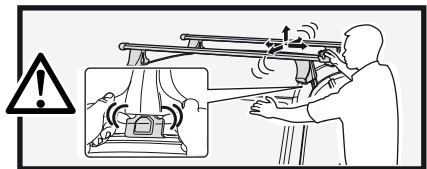

750

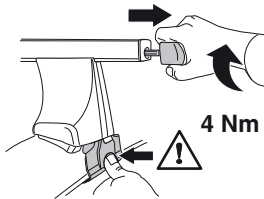

4 Nm

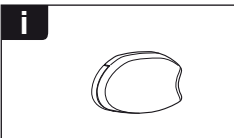
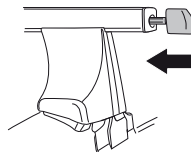

i

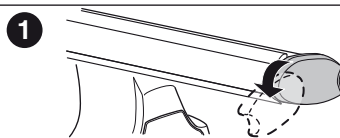

1

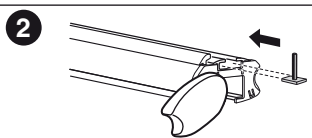

2

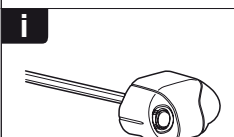

i

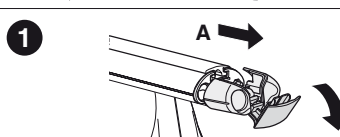

1

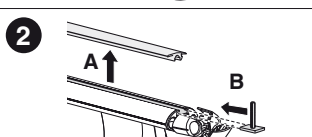

2

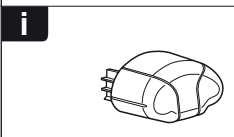

i

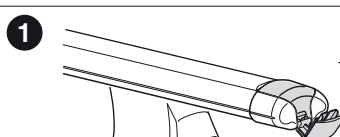

1

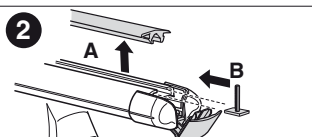

2

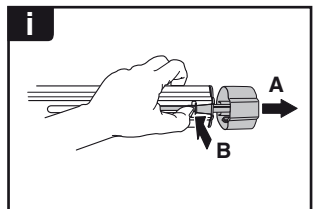
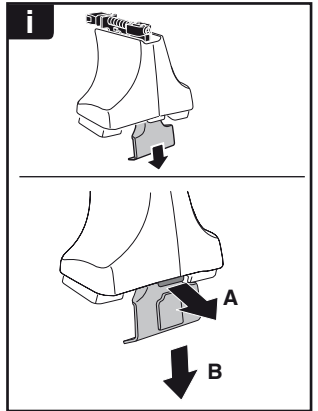
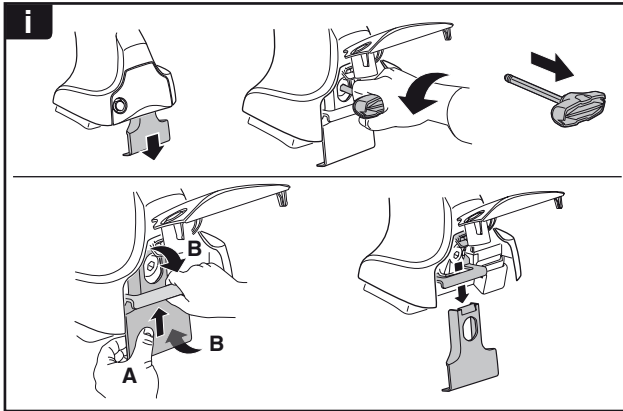
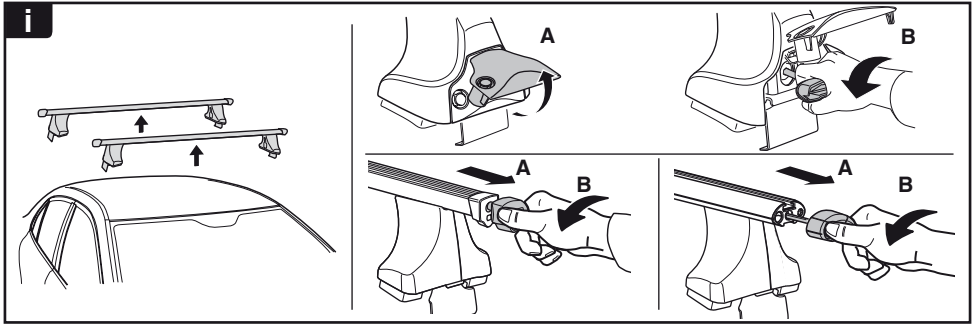

THULE
SWEDEN
**ONE
KEY
SYSTEM**

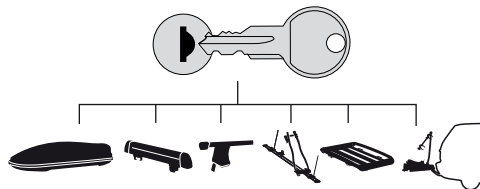

- 544 (x4)
- 596 (x6)
- 588 (x8)
- NA 510 (x10)
- EUR 452 (x12)
- ASIA

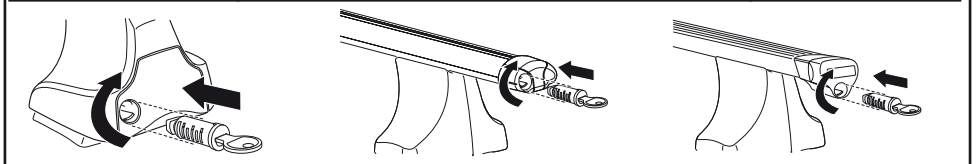

WW ▶ Thule Sweden AB, Box 69, 330 33 Hillerstorp, SWEDEN
NA ▶ Thule Inc., 42 Silvermine Road, Seymour, Connecticut 06483, USA

info@thule.com
customer.service@thule.com

www.thule.com