

**DeltaBar** - A reliable and durable roof bar system.

The high-tensile alloyed steel construction of Rhino's DeltaBar makes it one of the strongest roof bar systems on the market. Available for a range of commercial vehicles, their stylish and practical design means DeltaBars enhance both the appearance and storage capabilities of any van. Rigorously crash tested to 20g, twice the industry standard, DeltaBars are extremely safe. Bespoke fittings for every van come as standard, and a range of additional compatible accessories including a full width rear roller are also available.

DeltaBars are not only strong, but are extremely safe. They are a TUV GS certified product and crash tested to 20g - twice the industry standard.



**Fitting time**

## DIMENSIONS

Dimensions		Measurements
- Length	(L1)	1240mm - 1385mm - 1450mm - 1660mm - 1840mm
- Leg width	(W1)	120mm
- Fixing point to top of bar	(H1)	min. 106.2mm / max. 169.5mm
- Fixing point to underside of bar	(H2)	min. 63.7mm / max. 127mm
- Load stop height	(H3)	140mm

## WEIGHT

Bar length	Bar	Combined weight of two legs	Total weight
1240mm	1.98 kg	0.5 kg	2.48 kg
1385mm	2.21 kg	0.5 kg	2.71 kg
1450mm	2.31 kg	0.5 kg	2.81 kg
1660mm	2.65 kg	0.5 kg	3.15 kg
1840mm	2.94 kg	0.5 kg	3.44 kg

## LEG DESIGN

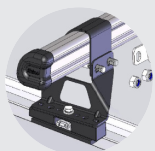

Special rubber pads are fitted underneath the DeltaBar's steel legs in order to provide a bespoke fitting for each vehicle.

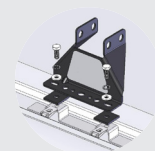

## ACCESSORIES



### Pair of Load Stops

140mm high, easy to adjust, constructed of glass filled nylon.



### Beacon holder

Mild steel construction combined with a power-coated and textured black finish.



### PipeTube Pro

Transportation and storage of lengthy materials, key lockable at both ends. Capacity: 50x15mm tubes/pipes.



## REAR ROLLER SYSTEM

### Dimensions

- Roller length
- Support arm length
- Max. payload per roller

### Measurements

- 620mm - 750mm - 1000mm - 1145mm - 1275mm
- 140mm - 225mm - 275mm - 300mm - 375mm
- 450mm - 500mm - 550mm
- 50kg

### Rear Roller System

- Stainless steel roller with glass filled nylon end caps
- Highly adjustable high-tensile alloyed steel arms with pad feet
- Available in various widths to accommodate all vehicle sizes

### MATERIAL

#### Alloy Steel

- E320 + CR2

### WHERE USED

- Cross tubes

### ADVANTAGES

- High tensile, yield strength

#### Composite

- Polypropylene (PPCP)

- Cross tube end cap

#### Mild steel

- Mild steel CR4

- Bar leg
- Bar saddle
- Clamp
- Roller
- Roller support arms

- High strength
- Corrosion resistant
- Leg and saddle are powder coated

#### Fixings

- Size M8 8.8 grade steel bolts, A2 stainless steel M8 nuts

#### Tools required for installation

- 10mm spanner, 13mm spanner, allen key (included)

