

# Kit 1391

**SUZUKI Swift**, 5-dr Hatchback, 05–  
**SUZUKI Swift+**, 5-dr Hatchback, \*04-06

\*North America

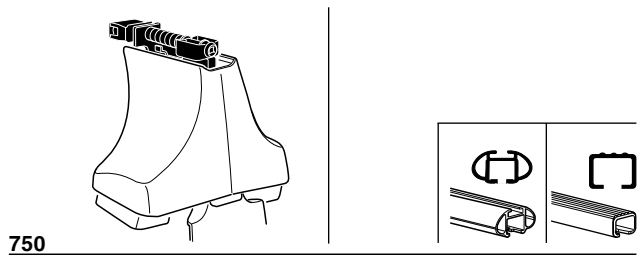
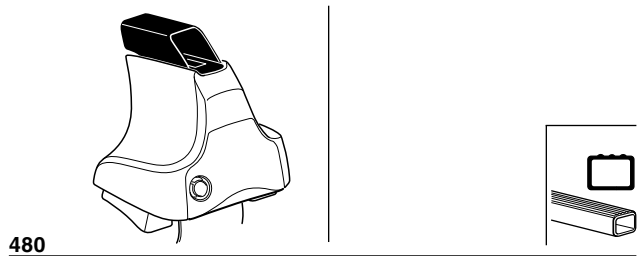
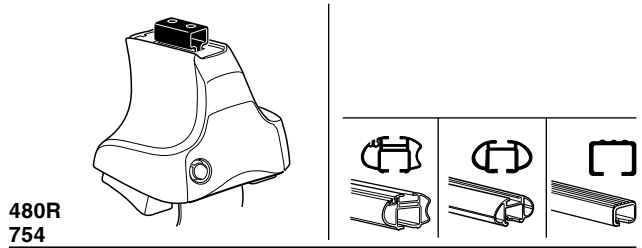

x2 x2 x2 x4	x2	x2 x2 x4 x4	x2 x2	x2

**753** x 4

**221** x 4

**x 1**

**Kit**

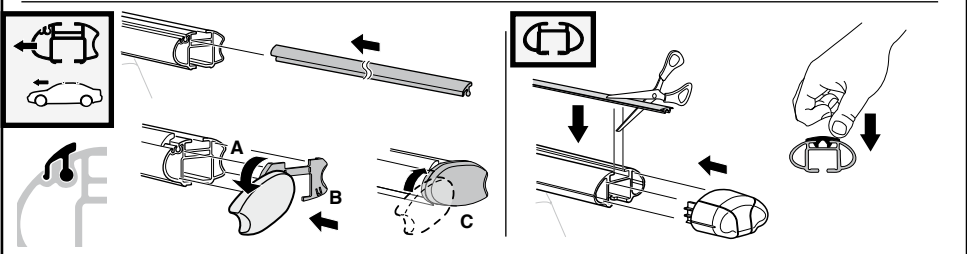
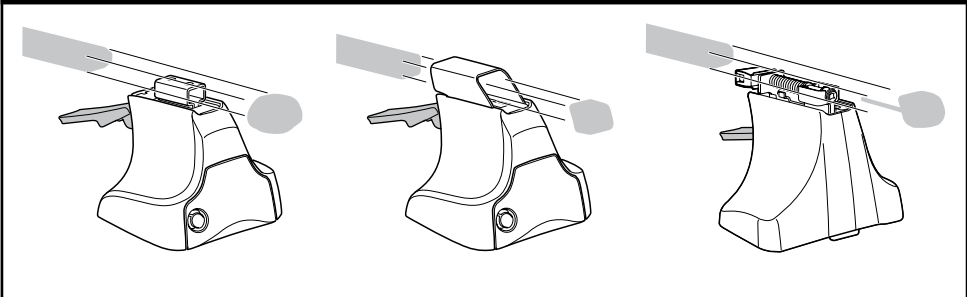

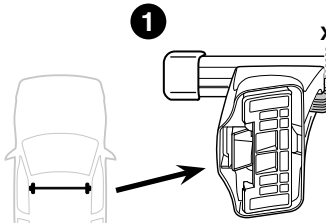
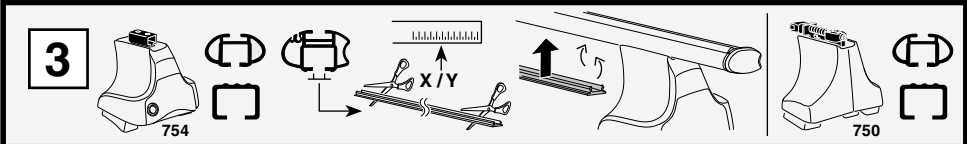

	X
SUZUKI Swift, 5-dr Hatchback, 05-	21.5
SUZUKI Swift+, 5-dr Hatchback, *04-06	21.5

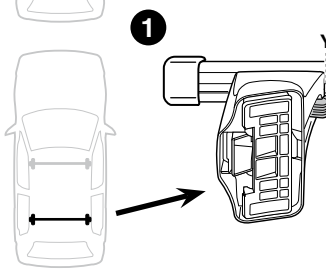

	Y
SUZUKI Swift, 5-dr Hatchback, 05-	17.5
SUZUKI Swift+, 5-dr Hatchback, *04-06	17.5

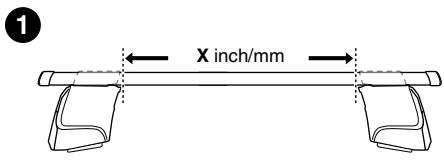
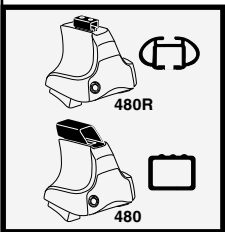
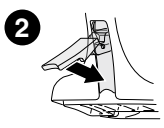

	X inch	X mm
SUZUKI Swift, 5-dr Hatchback, 05-	34 1/8"	866 mm
SUZUKI Swift+, 5-dr Hatchback, *04-06	34 1/8"	866 mm

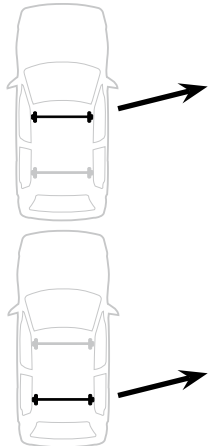
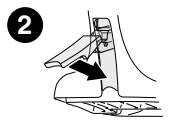

	Y inch	Y mm
SUZUKI Swift, 5-dr Hatchback, 05-	32 1/2"	826 mm
SUZUKI Swift+, 5-dr Hatchback, *04-06	32 1/2"	826 mm

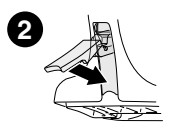

4

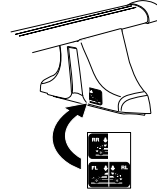
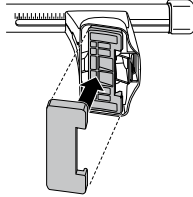
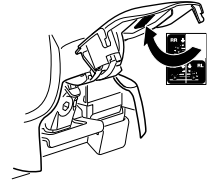
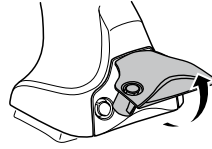
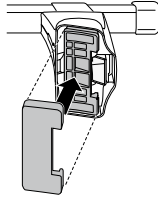
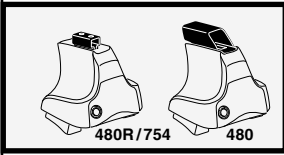

5

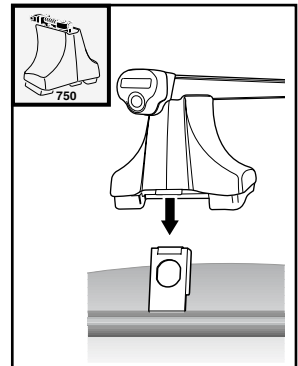
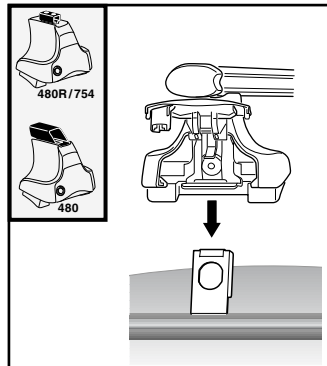
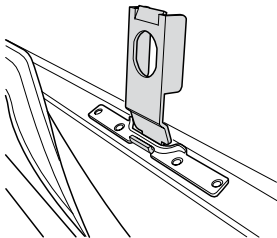
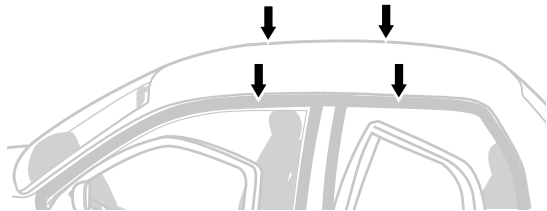
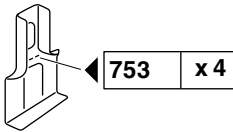
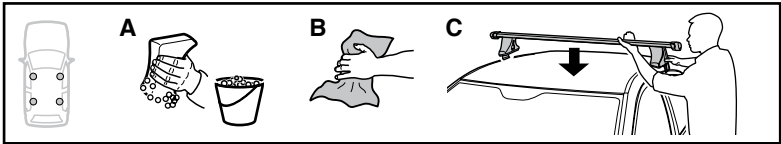

6

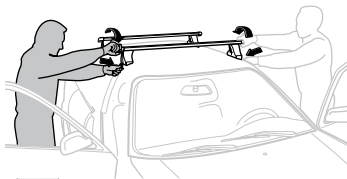
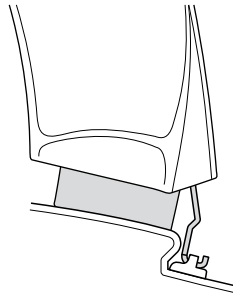
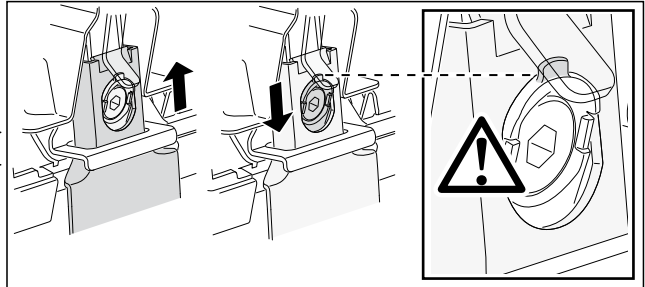
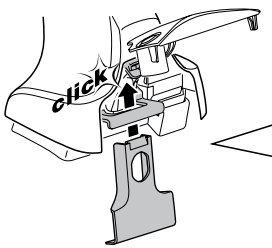

**GB/US** Tighten alternately

**D** Die Schrauben abwechselnd anziehen

**F** Serrer alternativement chaque côté

**NL** Afwisselend aan de linker- en de rechterkant aandraaien

**I** Alternare il serraggio delle viti

**E** Serrare alternativamente

**PT** Aperte alternadamente

**S** Dra åt växelvis

**FIN** Kierrä vuorotellen

**EST** Pinguldage vaheldumisi

**LAT** Pievelciēt pamišus

**LIT** Užsukinėkite pakaitomis

**PL** Śruby dokręcaj naprzemiennie

**RU** Затягивайте попеременно

**CZ** Pokręťta багаžnika dokręcaj dokręcaj naprzemiennie.

**SK** Doťahujte striedavo

**SLO** Privijajte izmenično.

**HR** Naizmjenično zategnite

**HU** Egymástól fűggetlenül szorítandó

**GR** Σφιγγετε εναλλάξ

**TR** Dönüşümlü sıkın

**中文** 交替拧紧

**한국어** 번갈아 가며 조이십시오.

**日本語** 交互に締め付けてください。

**ไทย** ชันในแบบสลับ

6



480R/754



480

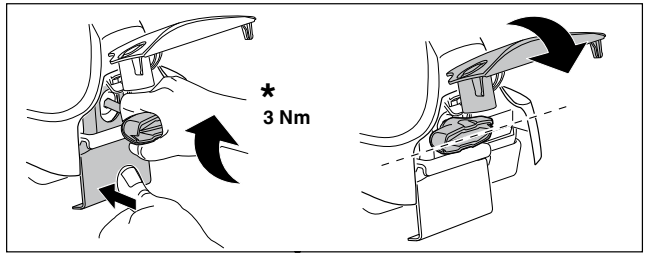
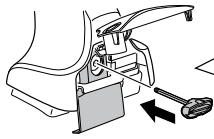

\*  
3 Nm



\*

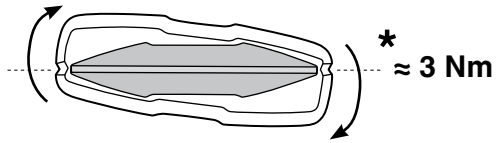

\*  
≈ 3 Nm

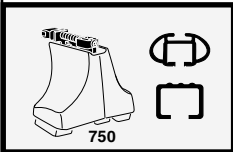
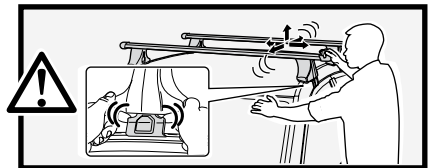

750

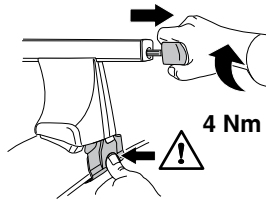

4 Nm

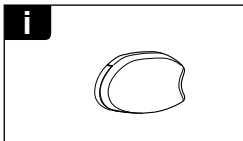
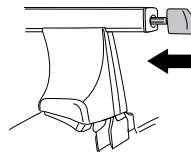

i

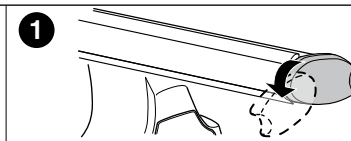

1

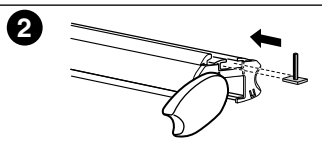

2

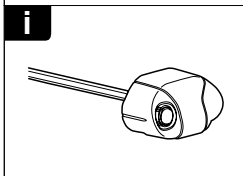

i

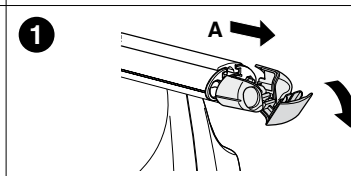

1

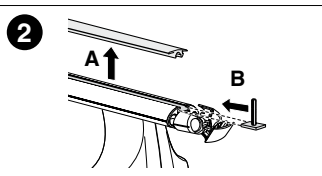

2

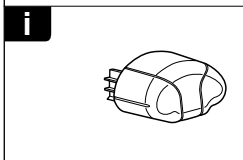

i

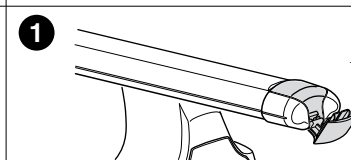

1

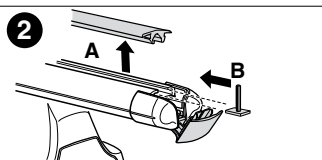

2

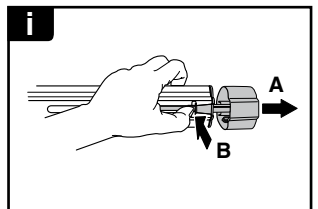
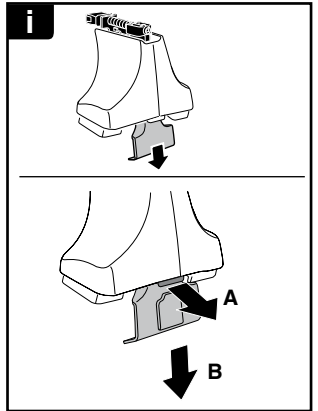

**THULE**  
SWEDEN  
**ONE  
KEY  
SYSTEM**



		(x4)
<b>544</b>		(x6)
<b>596</b>		(x8)
<b>588</b>		(x10)
NA <b>510</b>		(x12)
EUR		
ASIA <b>452</b>		



ww ▶ Thule Sweden AB, Box 69, 330 33 Hillerstorp, SWEDEN  
NA ▶ Thule Inc., 42 Silvermine Road, Seymour, Connecticut 06483, USA

info@thule.com  
customer.service@thule.com

www.thule.com

503-1391-02